



«MAGNITO-KONTAKT» Ltd

51B, place H4, Novaya St., 390027 Ryazan, Russia, phone +7 915 622-20-57
 E-mail: 453788@bk.ru; 451694@bk.ru /m-kontakt.ru/ /m-kontakt.com/

EXPLOSION-PROOF MAGNETIC CONTACT SECURITY DETECTOR Ex IO 102



**1Ex db IIC T6...T5 Gb / PB Ex db I Mb; 1Ex db IIC T6...T5 Gb /
 1Ex db IIC T6...T5 Gb X / PB Ex db I Mb X; 1Ex db IIC T6...T5**

**INGRESS PROTECTION RATING
 IP66/IP68**

Description

The detectors consist of two components - a magnetically controlled sensor (reed switch unit) and a control element (magnet block).

The units are housed in cylindrical metal enclosures made of aluminum alloy or stainless steel.

The reed block has a side cable gland.

Cable gland material: stainless steel, steel with anti-corrosion coating, brass, brass with anti-corrosion coating.



SIDE CONNECTION



ATTACHED CABLE

Cable gland is manufactured with different types of nozzles:

- For Ø6-14mm, Ø6-18mm cable laying
- For Ø6-14mm, Ø6-18mm armored cable laying
- For cable laying in tubes with coupling thread G-3/4
- For cable in metal hose or for Ø8 mm cable in metal hose with permanent connection or for Ø18 mm armored cable laying with permanent connection

Operating temperature from - 60°C to + 95°C.

Weight: reed switch unit - 0.65 kg, magnet block - 0.48 kg.

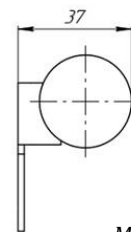
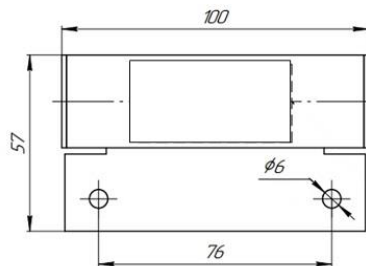

MAGNET BLOCK

Dimensions

Dimensions in mm

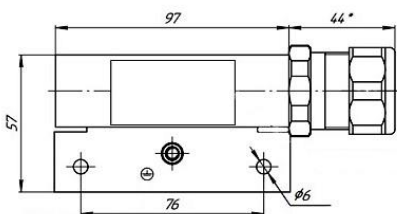

REED SWITCH UNIT WITH SIDE CONNECTION

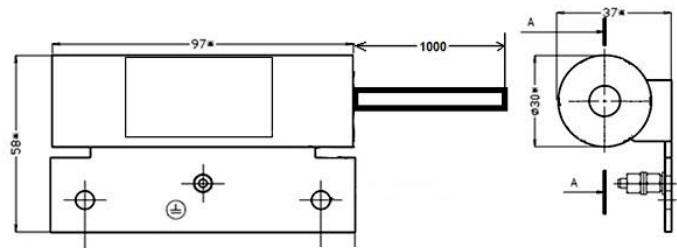
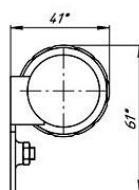

REED SWITCH UNIT WITH ATTACHED CABLE

Technical data

Execution type	Sensing distance
Ex IO 102 ver.200 (magnet M100/M200)	55mm/35mm
Ex IO 102 ver.300 (magnet M100/M200)	50mm/30mm
Ex IO 102 ver.201 (magnet M111)	25mm
Ex IO 102 ver.301 (magnet M111)	15mm